



SCOTIA

Hazelwood Blairgowrie
Plot 018
HT85 - Harkwood - RH

Issue B. 26.07.2022 Internal Statement Update
Issue A. 03.05.2022 Internal Statement Update

Drawing Ref : 1550-018-SD26 Issue Ref : B

HAZELWOOD, BLAIRGOWRIE

Plot 018 - HT85 - Harkwood - RH

- Note : Any deviation to the currently compliant electrical layout to be in accordance with the Technical Standards Handbook 2011.
- All dimensions are in millimeters unless noted otherwise.

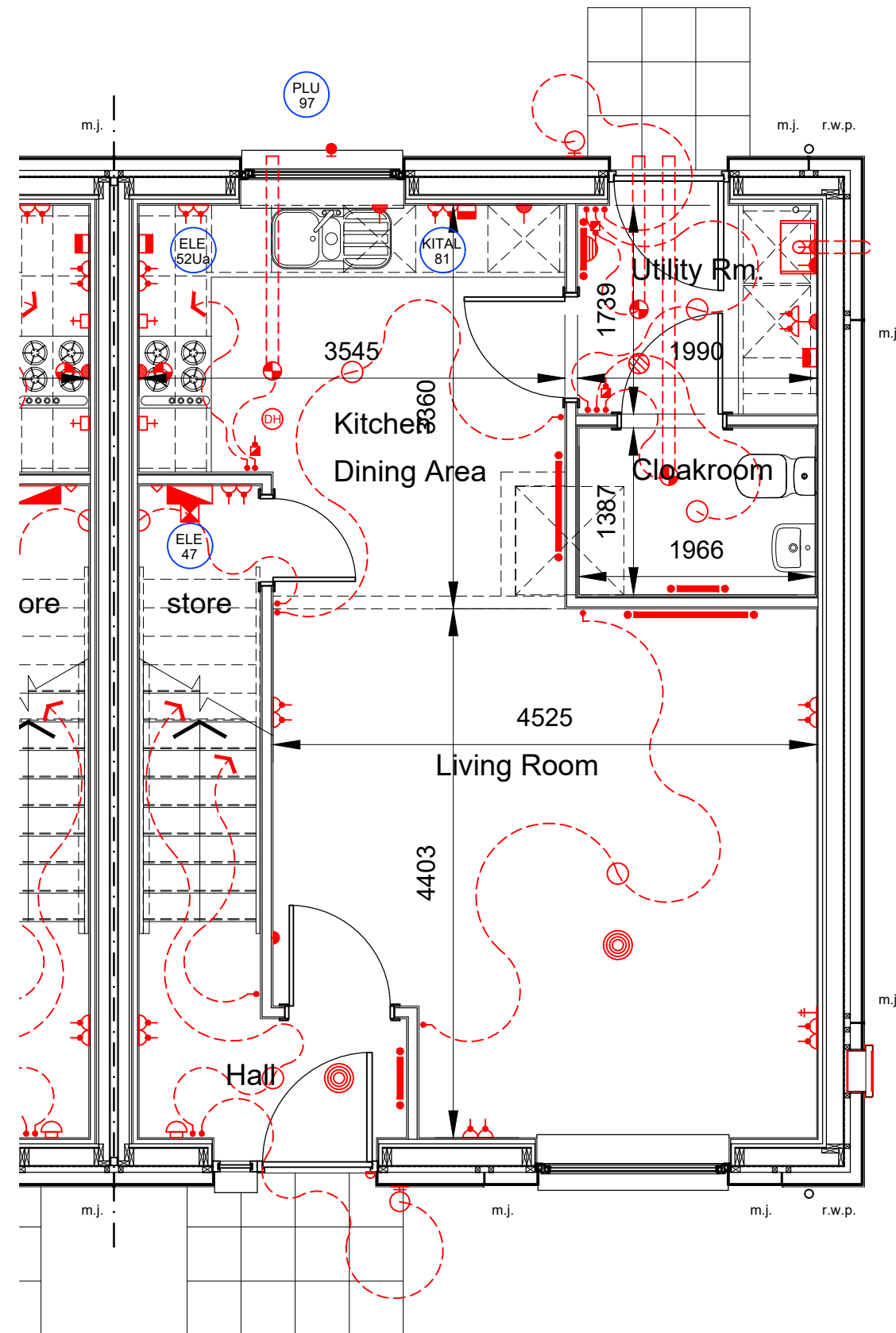

Ground Floor Plan 1:50

HAZELWOOD, BLAIRGOWRIE

Plot 018 - HT85 - Harkwood - RH

- Note : Any deviation to the currently compliant electrical layout to be in accordance with the Technical Standards Handbook 2011.
- All dimensions are in millimeters unless noted otherwise.

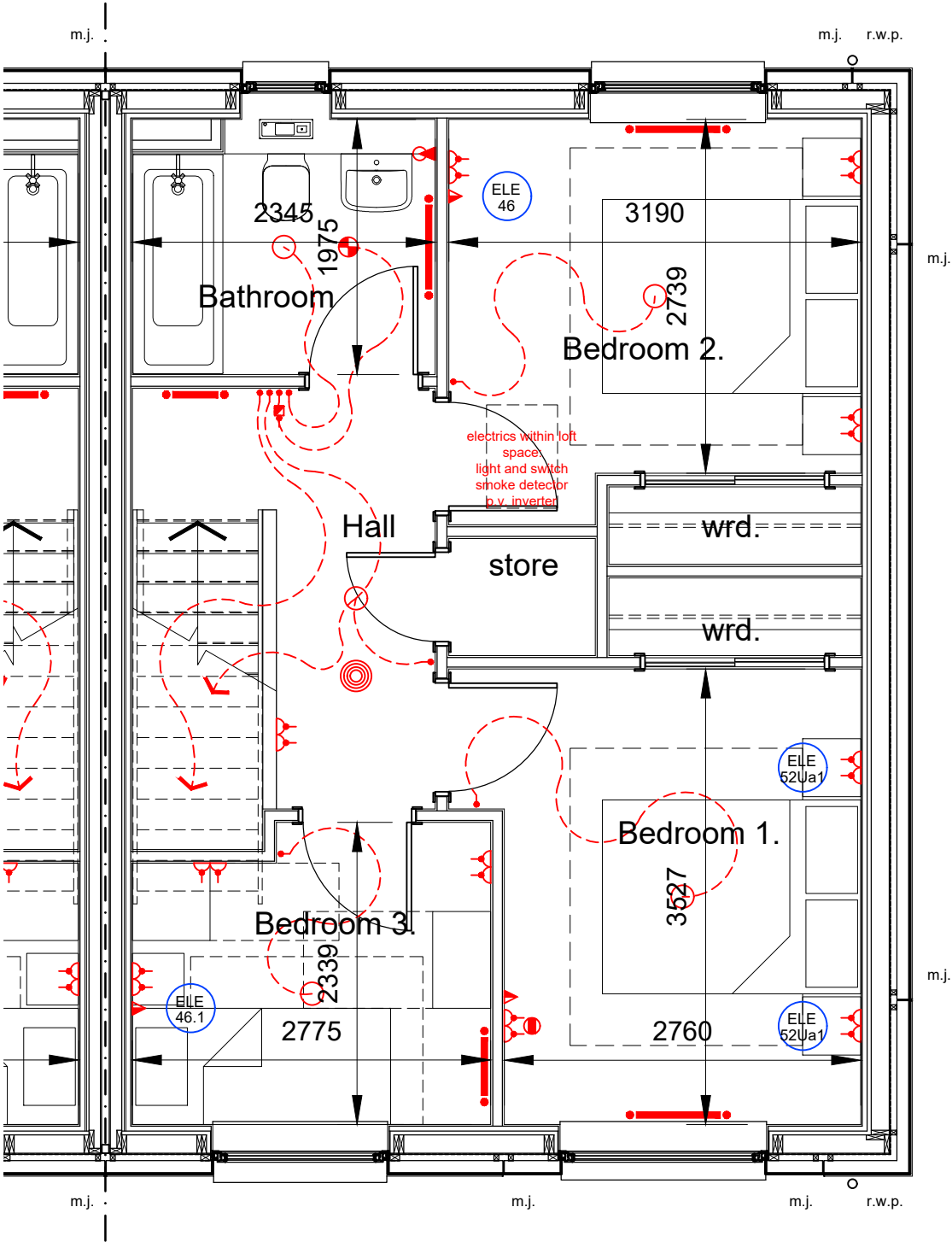

First Floor Plan 1:50



HAZELWOOD, BLAIRGOWRIE

Plot 018 - HT85 - Harkwood - RH

- Note : Any deviation to the currently compliant electrical layout to be in accordance with the Technical Standards Handbook 2011.
- All dimensions are in millimeters unless noted otherwise.



Front Elevation 1:100

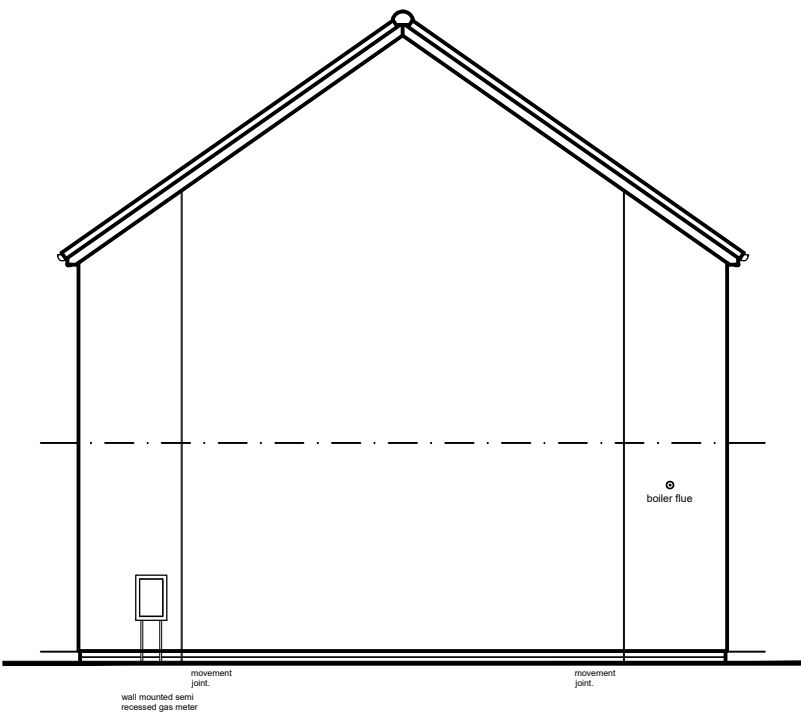

Side Elevation 1:100



Rear Elevation 1:100



SCOTIA

HAZELWOOD, BLAIRGOWRIE

Plot 018 - HT85 - Harkwood - RH

- Note : Any deviation to the currently compliant electrical layout to be in accordance with the Technical Standards Handbook 2011.
- All dimensions are in millimeters unless noted otherwise.

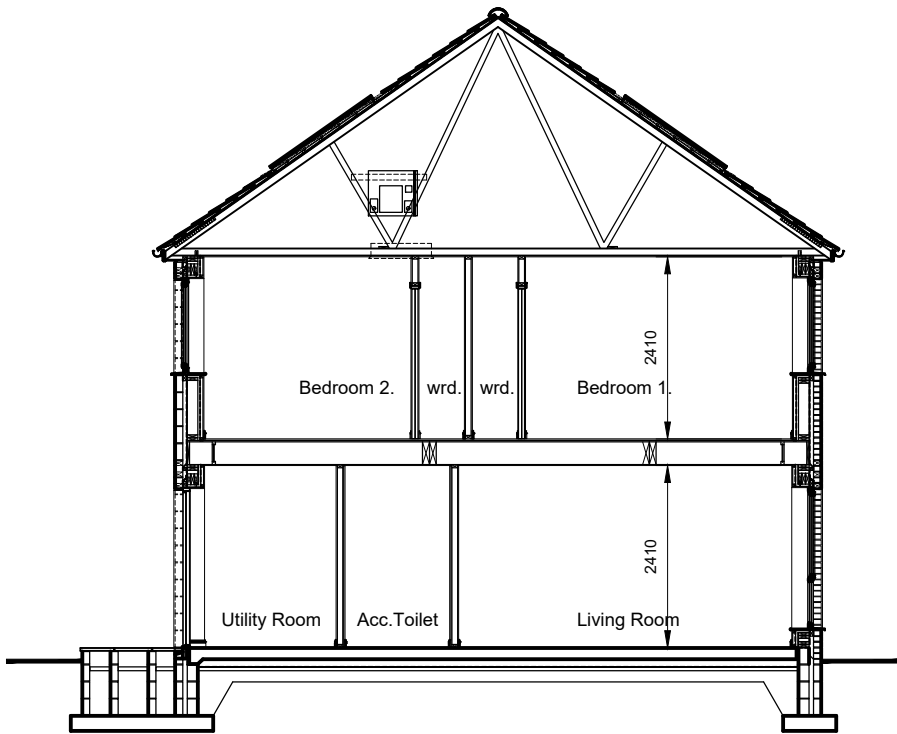

Section A-A 1:100

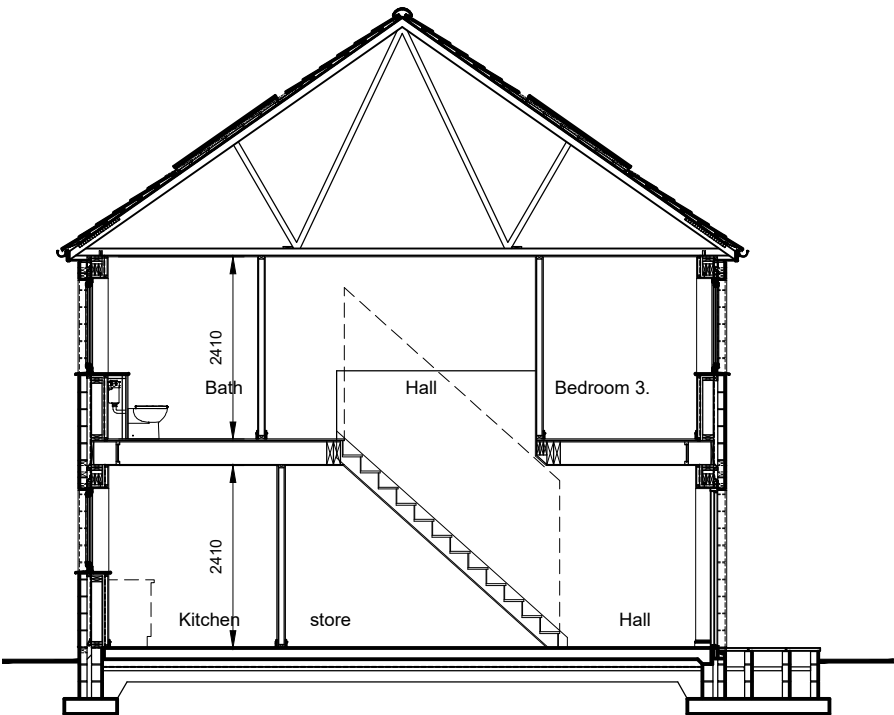

















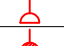

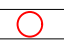







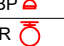



Section B-B 1:100

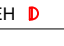
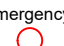
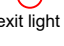

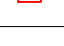
HAZELWOOD, BLAIRGOWRIE

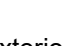
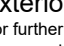
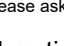
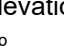
Plot 018 - HT85 - Harkwood - RH

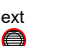

- Note : Any deviation to the currently compliant electrical layout to be in accordance with the Technical Standards Handbook 2011.
- All dimensions are in millimeters unless noted otherwise.

Electrical Legend.	
(all electrical points are to be located in accordance with general notes)	
	Twin 13 amp power socket
	Single 13 amp power socket
	Twin 13 amp power socket- surface mounted within garage
	BT / Digital TV / satellite multi point
	Master BT point
	BT point - client extra
	Extract fan
note : recirculating fan above cooker with separate extract fan ducted externally within kitchen.	
	45 amp oven - hob controls
	13 amp fused spur at low level with switched outlet at high level.
	13 amp fused spur at high - low level (to suit) with switched outlet at grid switch.
	13 amp fused spur - surface mounted within garage
	Multi grid switch
	Switch point
	Pendant light fitting
	Low voltage downlighter
	Shaver point - min. 150mm above any projecting surface ie. vanity worktop
	Central heating time clock
	Heating remote sensor
	Electrical consumer unit
	Smoke alarm to BS 5446 : Part 1 : 2000 wired to protected circuit.
	Heat detector
CO 	Carbon monoxide detector
CO  HD	Combined Carbon monoxide - heat detector
CO2 	Carbon dioxide detector - within principal bedroom
	Radiator / heating panel
	Doorbell sounder
DBP 	Doorbell push pad
PIR 	External light with PIR for automatic illumination
	Mechanical extract fused isolator switch
	Security alarm key pad - with associated control panel and fused spur outlet located with vestibule cupboard.
	Category 5 outlet
	8 way digital socket complete with switched socket on wall above / adjacent to electrical consumer unit.
	Television Point
	Ceiling mounted lighting track to client specification.
	'Add on' multi-switch for Sky Q
	13 amp fused spur at low level.
DES 	External - wall mounted - door entry system call / display panel.
DEH 	Internal - wall mounted - door entry system handset.
emergency exit light 	emergency lighting an emergency lighting system is to be designed and installed within the escape stair enclosure to come into, or remain in, operation automatically in the event of a local and general power failure. the emergency lighting should be installed in accordance with BS 5266: Part 1: 2005 as read in association with BS 5266: Part 7: 1999 (BS EN: 1838:1999).
FSVC 	fire service ventilator control switch located at entry point to building and locally to uppermost window within stair enclosure to provide control to automatically open ventilators by the fire service.
SPV 	solar photovoltaic cell provision: to consist of a pv inverter, pv ac isolation switch and a dc isolation switch with all to be mounted on generic board within loft space. pv generation meter and pv ac isolation switch to be located adjacent to mains distribution board.

Exterior Finishes

For further details on exterior finishes & colours please refer to exterior finishes palette.
Please ask sales advisor for further details.

Elevation Key

rwp	: rain water downpipe
m.j.	: movement / contraction joint location
 ext tile vent	: mechanical extract fan / duct terminal location via roof tile vent.
 svp tile vent	: soil vent pipe terminal location via roof tile vent.
 ext vent	: mechanical extract fan / duct terminal location via through wall vent.
BJR	: bed joint reinforcement
VCB	tenmat intumescent ventilated cavity barriers.



The Small Print

This drawing is intended for illustration purposes only and may change for example in response to market demand, ground conditions, local authority and NHBC etc. Consequently, it should be treated as general guidance and cannot be relied upon as accurately describing any of the specified matters prescribed by any order made under the Property Misdescriptions Act 1991. Nor do the contents constitute a contract, part of a contract or warranty. Room sizes are thereby. For clarification, please ask for details.

HAZELWOOD, BLAIRGOWRIE

Plot 018 - HT85 - Harkwood - RH

- Note : Any deviation to the currently compliant electrical layout to be in accordance with the Technical Standards Handbook 2011.
- All dimensions are in millimeters unless noted otherwise.

